

60cm 'Victoria' Induction hob with St/Steel Frame
EAN13: 8017709275839

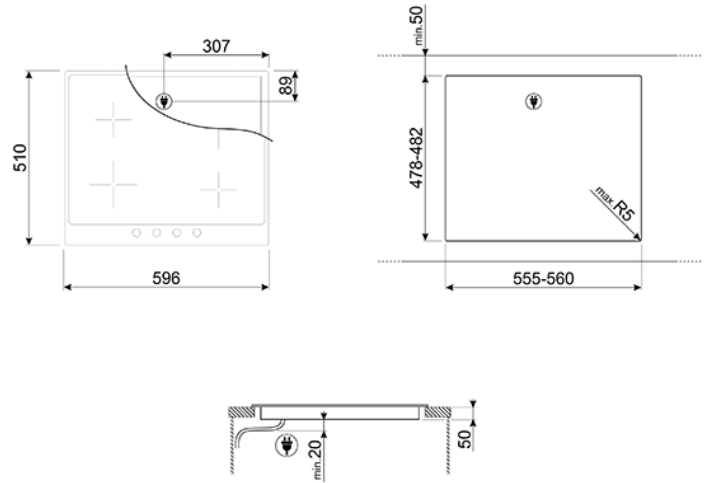

• Special promotion on this model* 5 year guarantee on parts and labour if purchased by 31st December 2019. • Terms and conditions apply. At selected displaying retailers only. [For full terms and conditions please click here](#) •



• 4 “full power” induction zones including: • Front right: Ø 160mm, 1.3kW – Booster 1.4kW • Rear right: Ø 230mm, 2.3kW –Booster 3.0kW • Rear left: Ø 160mm, 1.3kW –Booster 1.4kW • Front left: Ø 230mm, 2.3kW –Booster 3.0kW • 9 power levels • 4 independent boosters (P) • Quick start • Eco logic • Automatic pan diameter adjustment • Pan presence detection • Indication of the minimum pan diameter • Automatic switch off when overheat • Protection against auto-start up • Child safety lock • **Nominal power: 7.40kW** • Supply can vary depending on usage, please consult a qualified electrician for ampere requirement • NB: Only pans with a ferrous (magnetic) base are suitable for induction hobs

Versions

• SI964PM - 60cm 'Victoria' induction hob with Cream frame • SI964XM - 60cm 'Victoria' induction hob with st/st frame • SI964NM - 60cm 'Victoria' induction hob with black frame